

SUPPORT

ADJUSTABLE SUPPORT FOR DECKS

THREE VERSIONS

The Small version (SUP-S) can be raised by up to 37 mm, the Medium version (SUP-M) by up to 220 mm and the Large version (SUP-L) by up to 1025 mm. All versions are adjustable in height.

STRENGTH

Sturdy system suitable for heavy loads. The Small (SUP-S) and Medium (SUP-M) versions can handle up to 400 kg. The Large version (SUP-L) can handle up to 1000 kg.

COMPATIBLE

All versions can be combined with a special head to facilitate lateral or upper fastening to the batten, which may be made of either timber or aluminium. A tile adapter is also available on request.

NEW "ALL IN ONE" SUP-L

It features not only excellent adjustability and load-bearing capacity, but also versatile, self-levelling heads that can automatically correct the slope of uneven installation surfaces by up to 5%; thanks to the SUPKEY key, it can be adjusted from above for maximum stability in tile flooring systems.



USE

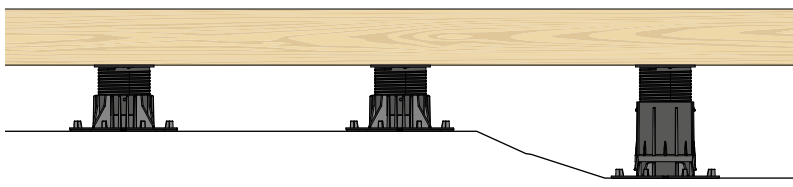

MATERIAL

PP

polypropylene (PP)



FIELDS OF USE

Substructure raising and levelling.
Outdoor use.



DURABILITY

UV-resistant and suitable also for aggressive environment conditions. Ideal in combination with ALU TERRACE and KKA screws to create a system with excellent durability.

ADJUSTMENT FROM TOP

Thanks to the SUPLKEY key, it is adjustable from the top for maximum stability in tile flooring systems.

CODES AND DIMENSIONS - SUP-S



CODE	Ø [mm]	H [mm]	pcs
1 SUPS2230	150	22 - 30	20
2 SUPS2840	150	28 - 40	20

INTERLOCKING HEAD FOR SUP-S

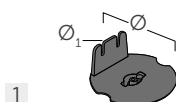

CODE	Ø [mm]	Ø ₁ [mm]	pcs
1 SUPSLHEAD1	70	3 x 14	20

CODES AND DIMENSIONS - SUP-M

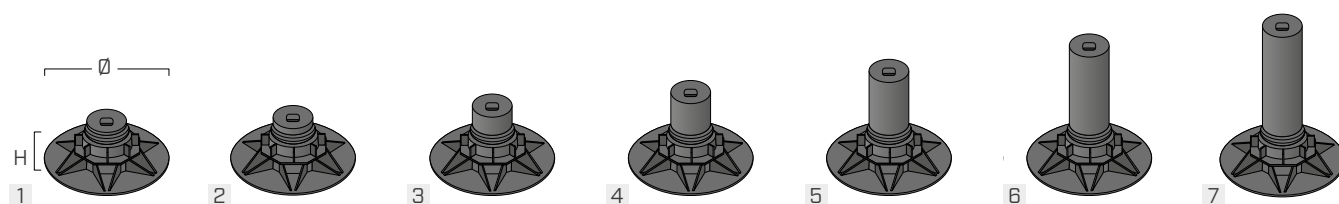

CODE	Ø [mm]	H [mm]	pcs
1 SUPM3550	200	35 - 50	25
2 SUPM5070	200	50 - 70	25
3 SUPM65100	200	65 - 100	25
4 SUPM95130	200	95 - 130	25
5 SUPM125160	200	125 - 160	25
6 SUPM155190	200	155 - 190	25
7 SUPM185220	200	185 - 220	25

INTERLOCKING HEAD FOR SUP-M

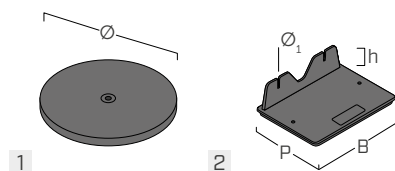

CODE	B x P x H [mm]	Ø [mm]	Ø ₁ [mm]	pcs
1 SUPMHEAD1	-	120	-	25
2 SUPMHEAD2	120 x 90 x 30	-	3 x 14	25

EXTENSIONS AND SLOPE ADAPTERS FOR SUP-M

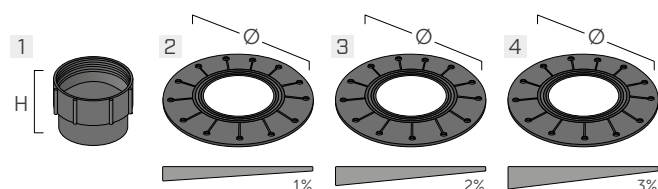

CODE	H [mm]	Ø [mm]	%	pcs
1 SUPMEXT30	30	-	-	25
2 SUPCORRECT1	-	200	1	20
3 SUPCORRECT2	-	200	2	20
4 SUPCORRECT3	-	200	3	20

CODES AND DIMENSIONS - SUP-L

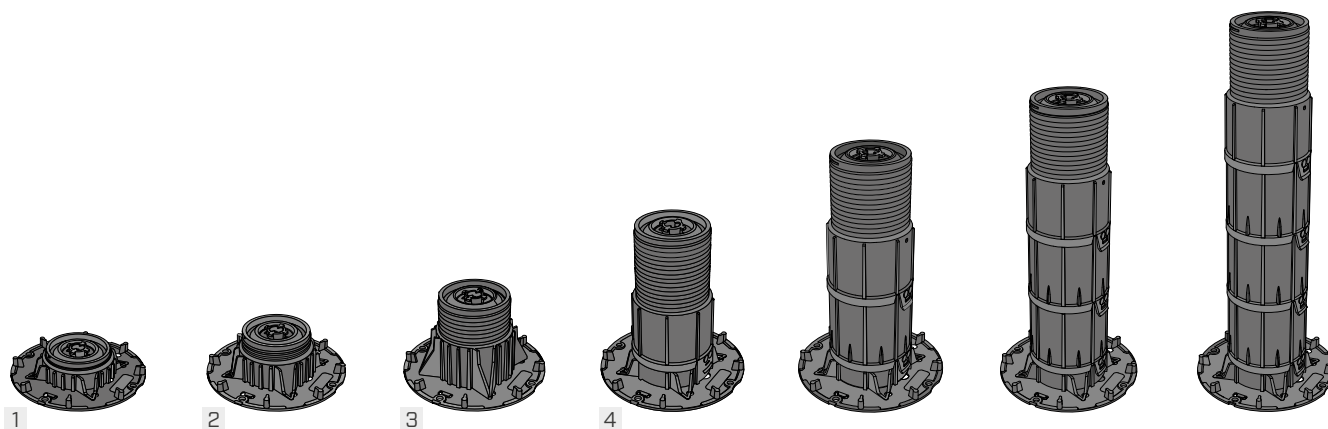

CODE	Ø [mm]	H [mm]	pcs
1 SUPL3750(*)	200	37 - 50	20
2 SUPL5075(*)	200	50 - 75	20
3 SUPL75125(*)	200	75 - 125	20
4 SUPL125225	200	125 - 225	20
5 SUPL225325	200	225 - 325	20
6 SUPL325425	200	325 - 425	20
7 SUPL425525	200	425 - 525	20
8 SUPL525625	200	525 - 625	20
9 SUPL625725	200	625 - 725	20
10 SUPL725825	200	725 - 825	20
11 SUPL825925	200	825 - 925	20
12 SUPL9251025	200	925 - 1025	20

(*) SUPLEXT100 extension not usable.

Head to be ordered separately.

Codes 5-12 consist of the product SUPL125225 and of a number of SUPLEXT100 extensions to reach the indicated height range.

INTERLOCKING HEADS FOR SUP-L

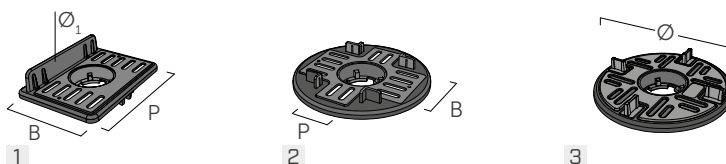

CODE	application	B x P [mm]	Ø [mm]	Ø ₁ [mm]	pcs
1 SUPLHEAD1	timber/aluminium battens	70 x 110	-	3 x 14	20
2 SUPLHEAD2	timber/aluminium battens	60 x 40	-	-	20
3 SUPLHEAD3	tiles	-	120	-	20

ACCESSORIES FOR SUP-L

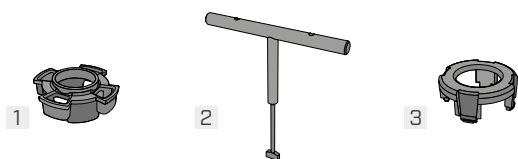

CODE	description	pcs
1 SUPLRING1	stem lock ring	20
2 SUPLKEY	key for adjustment from the top	1
3 SUPLRING2	rotation lock ring	5

SUPLKEY and SUPLRING2 only compatible with SUPLHEAD3 heads.
SUPLRING1 and SUPLRING2 are supplied together with the heads.

EXTENSIONS AND SLOPE ADAPTERS FOR SUP-L

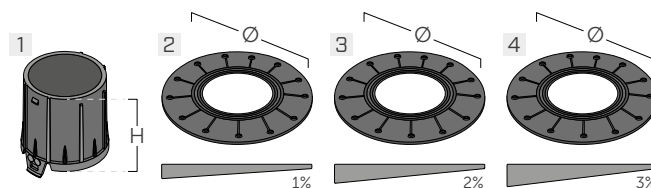

CODE	H [mm]	Ø [mm]	%	pcs
1 SUPLEXT100	100	-	-	20
2 SUPCORRECT1	-	200	1	20
3 SUPCORRECT2	-	200	2	20
4 SUPCORRECT3	-	200	3	20

■ INSTALLATION OF SUP-S WITH SUPSLHEAD1

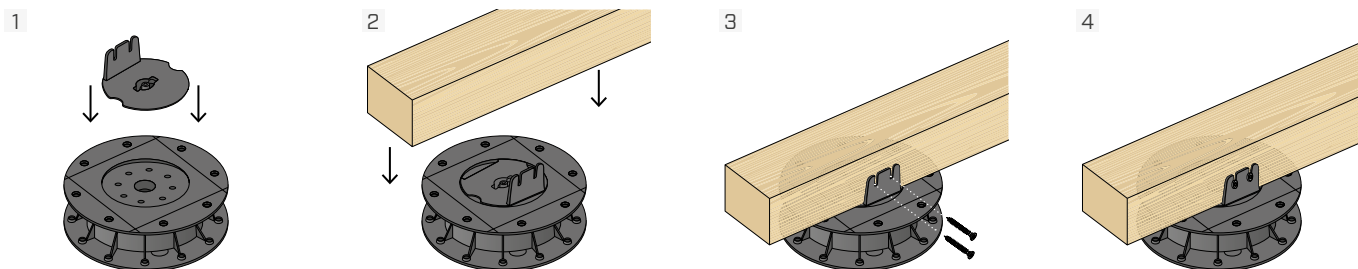

Fit the head SUPSLHEAD1 on the SUP-S and fix the batten with 4,5 mm diameter KKF screws.

■ INSTALLATION OF SUP-M WITH SUPMHEAD2

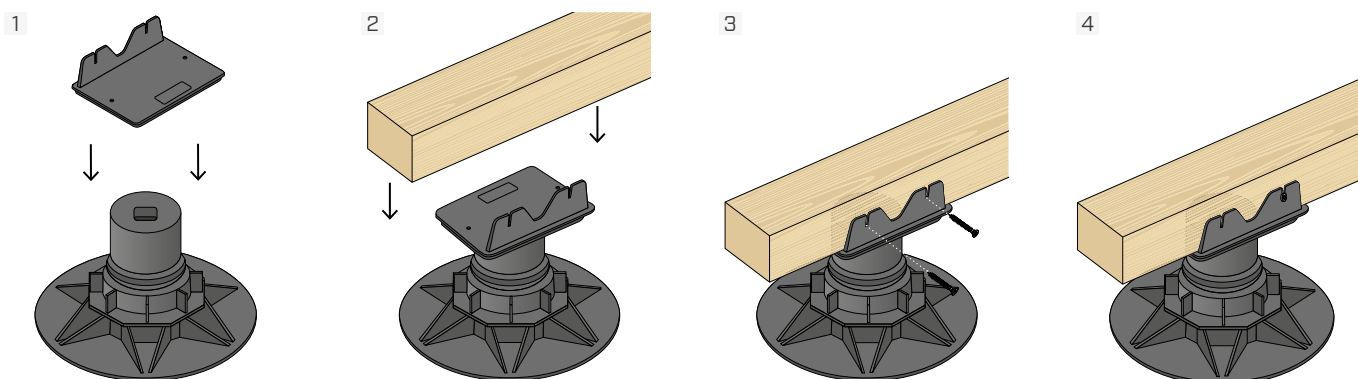

Fit the head SUPMHEAD2 on the SUP-M and fix the batten laterally with 4,5 mm diameter KKF screws.

■ INSTALLATION OF SUP-M WITH SUPMHEAD1

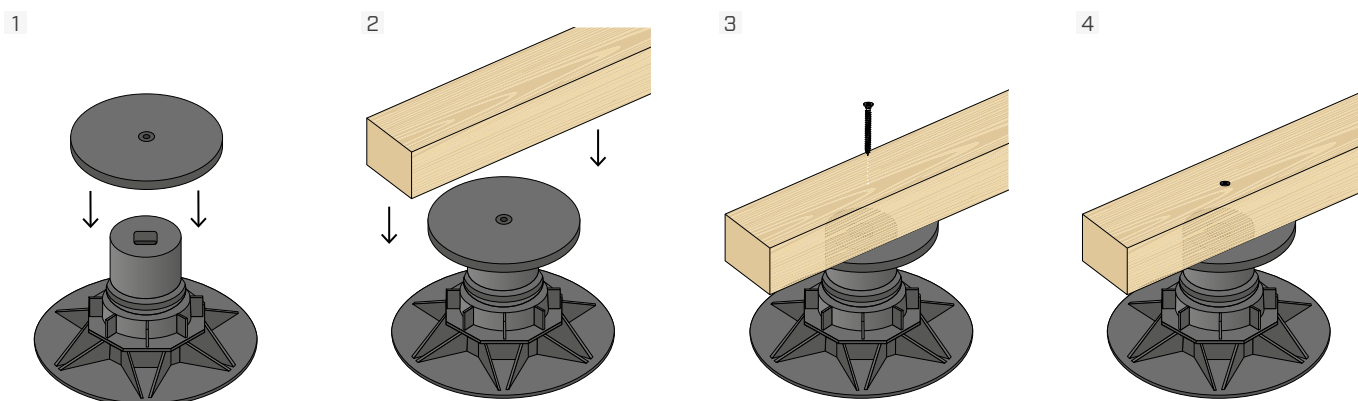

Fit the head SUPMHEAD1 on the SUP-M and fix the batten with KKF 4,5 mm diameter screws.

■ INSTALLATION OF SUP-L WITH SUPLHEAD1

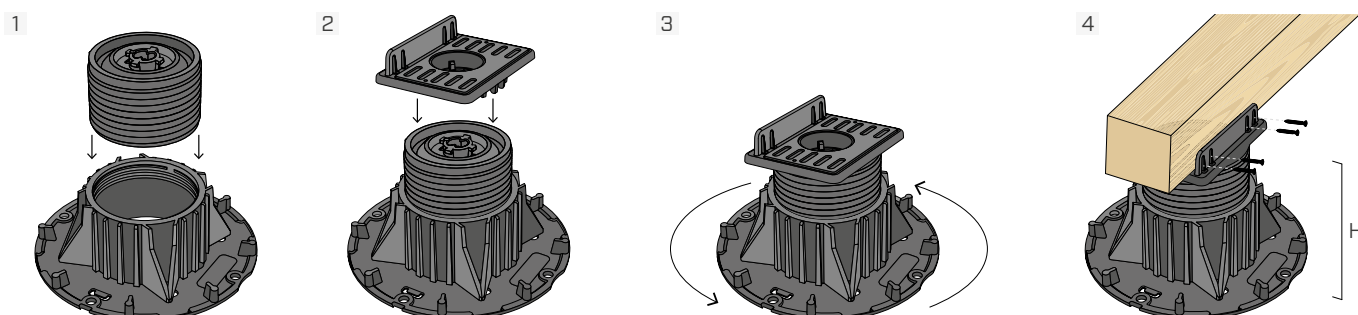

Fit the head SUPLHEAD1 on the SUP-L, adjust the height of the base as needed and fix the batten laterally with 4,5 mm diameter KKF screws. The tilting head allows self-levelling during installation for slopes of up to 5%.

■ INSTALLATION OF SUP-L WITH SUPLHEAD1 AND SUPLRING1

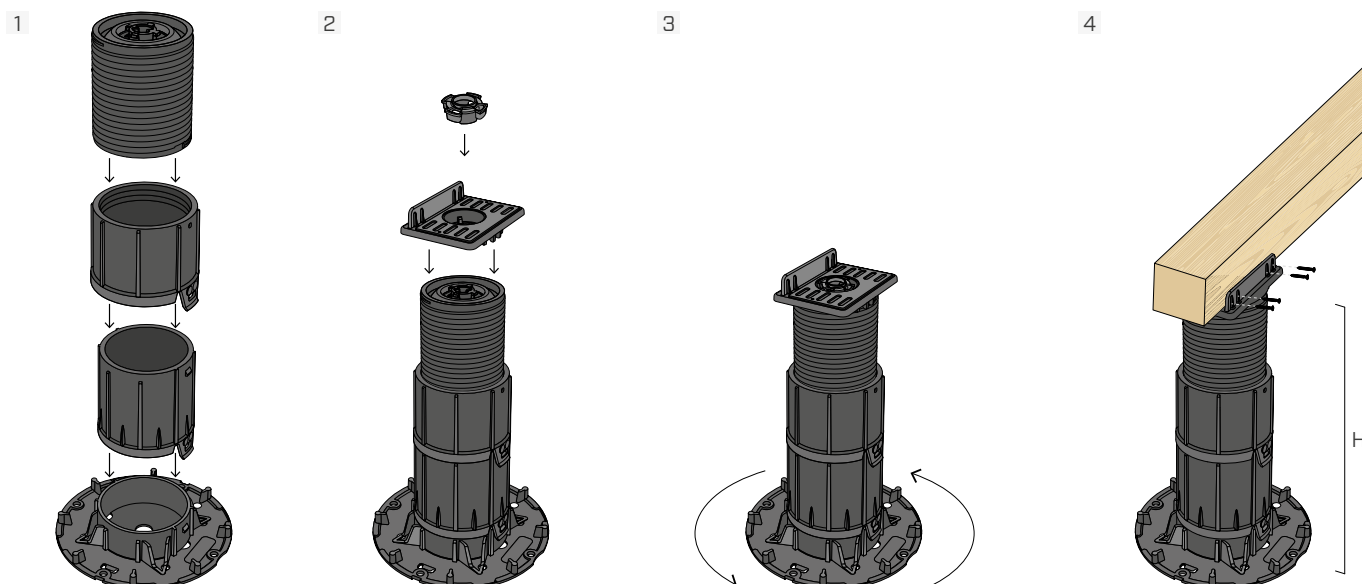

If provided, add the SUPLEXT100 extension to the SUP-L support and then fit the SUPLHEAD1 head. To lock the tilting of the self-levelling head, secure it with SUPLRING1. Adjust the height of the base as needed and fix the batten laterally with 4,5 mm diameter KKF screws.

■ INSTALLATION OF SUP-L WITH SUPLHEAD2 AND SUPLRING1

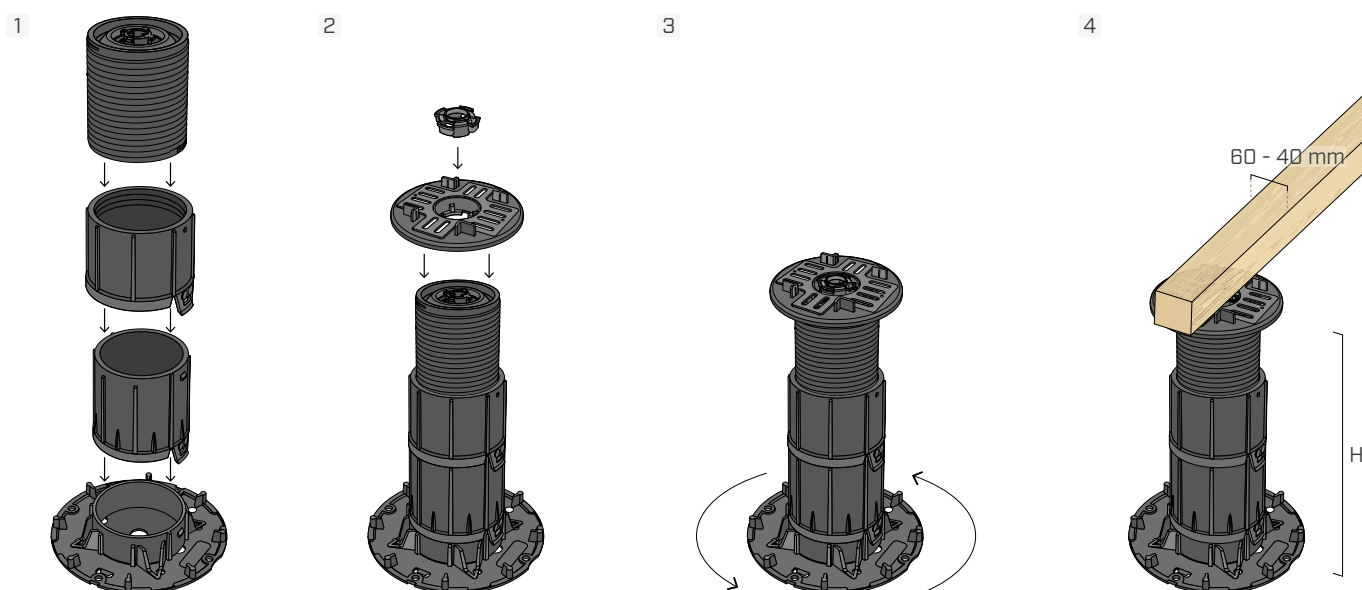

If provided, add the SUPLEXT100 extensions to the SUP-L support and then fit the SUPLHEAD2 head. To lock the tilting of the self-levelling head, secure it with SUPLRING1. Adjust the height as required and place the batten inside the fins.

■ INSTALLATION OF SUP-L WITH SUPLHEAD3 HEAD | HEIGHT ADJUSTMENT FROM TOP

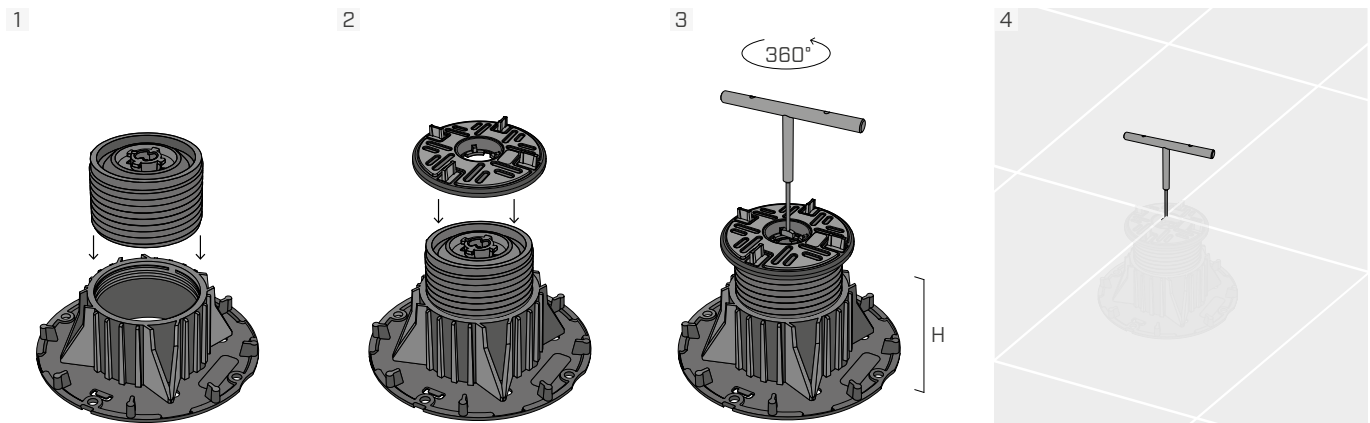

Fit the SUPLHEAD3 head on SUP-L. Adjust the height of the support using SUPLKEY. Place the tiles on the supports. Level the floor by adjusting the height of the supports from the top with SUPLKEY without having to remove the tiles already installed. The tilting head allows self-levelling during installation for slopes of up to 5%.

■ INSTALLATION OF SUP-L WITH SUPLHEAD3 HEAD | HEIGHT ADJUSTMENT FROM BOTTOM

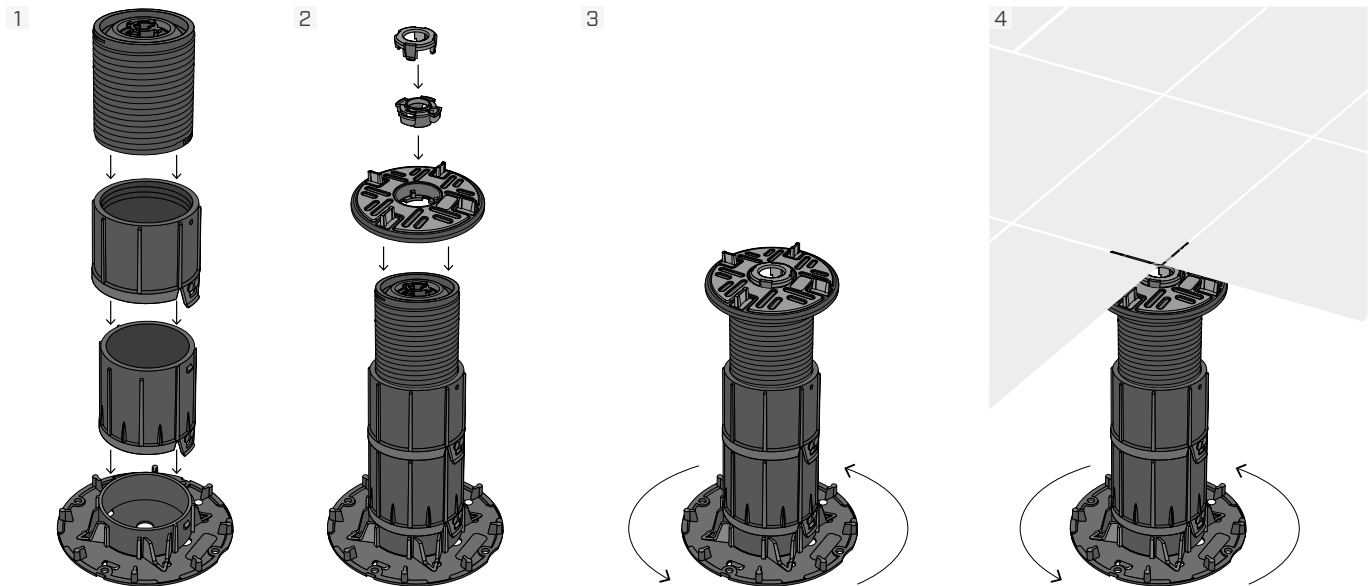

If provided, add the SUPLEXT100 extension to the SUP-L support and then fit the SUPLHEAD3 head. To lock the tilting of the self-levelling head, secure it with SUPLRING1. Position the SUPLRING2. Adjust the height as required and position the flooring.

■ CODES AND DIMENSIONS - FASTENING

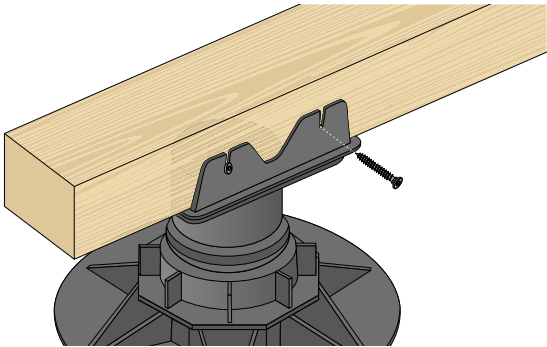

KKF AISI410

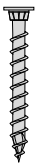

d ₁ [mm]	CODE	L [mm]	pcs
4,5 TX 20	KKF4520	20	200
	KKF4540	40	200
	KKF4545	45	200
	KKF4550	50	200
	KKF4560	60	200
	KKF4570	70	200

RECOMMENDATIONS FOR INSTALLATION

